

Panel mount plug with break-away locking

Size: 6 [STANAG 4695], IP68, Keying: 0, Number of contacts: 6, Solder cup, Contact type: Pins, USB® 2.0 [480 Mbit/s]



Basic information

Part number	GW6NOP-P06X230-0000
Category	Connector
Type of connector	Panel mount plug
Assembly situation	Rear panel mounting
Size	6 [STANAG 4695]

Contact insert description

Special features	Data transmission
Transmission type	USB® 2.0 [480 Mbit/s]
Number of contacts	6
Contact type	Pins
Contact diameter	0.7 mm
Termination type	Solder cup
Wire cross section AWG	AWG 22

Technical information

Nominal current single contact	5 A	EIA-364-70D
Test voltage	0.75 kV AC	EIA-364-20F:2019-02

All shown connectors are rated to a safety extra low voltage (SELV) of less than 50 V AC / 75 V DC, according to IEC 61140:2016 (VDE 0140-1:2016) Protection against electric shock - Common aspects for installation and equipment. In case other standards rule a specific use of the connector, the application specific safety criteria shall be considered first. In this context, lower voltage ratings may be valid. Warning: Danger to life for operating voltages above 50 V AC / 120 V DC!

Cable description

Cable outlet	Overmolding
--------------	-------------

Mechanical and environmental data

Locking principle	Break-Away
Mating cycles	2000
IP class	IP68
Max. operating temperature	71 °C
Min. operating temperature	-18 °C
Weight	9.999 g

*IP protection class refers to mated condition

Material and surface treatments

Material	Aluminum with black carbon finish
Insulator material	PEEK
Contact material	Cu-alloy with gold finish

ODU reserves the right to make changes based on the current state of knowledge without prior notice without being obliged to provide replacement deliveries or refinements of older designs.

All shown connectors are defined without breaking capacity (COC) according to IEC 61984:2008 (VDE 0627:2009).

Graphics and technical drawings

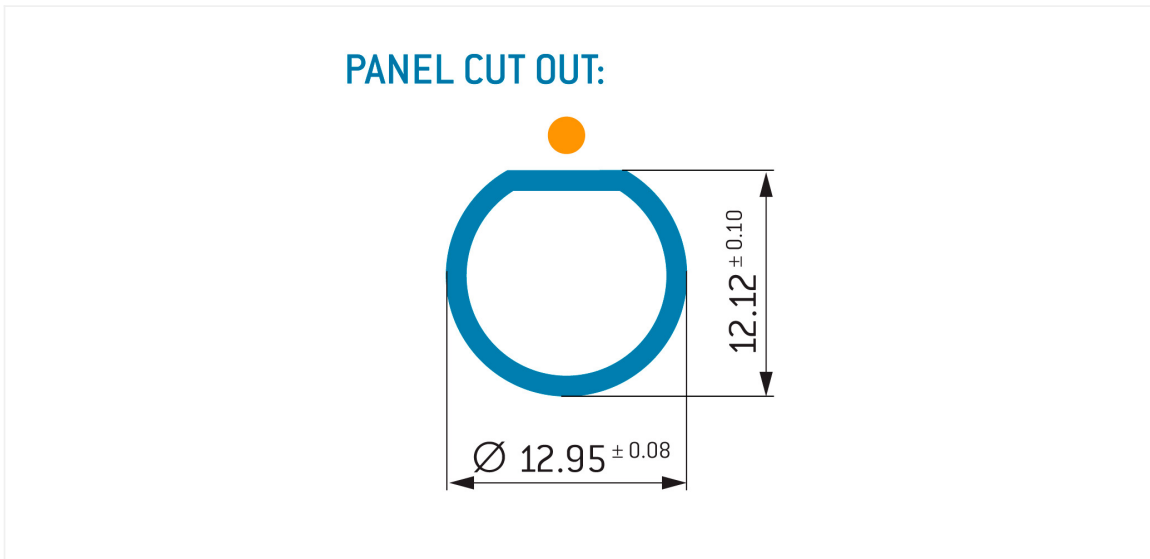
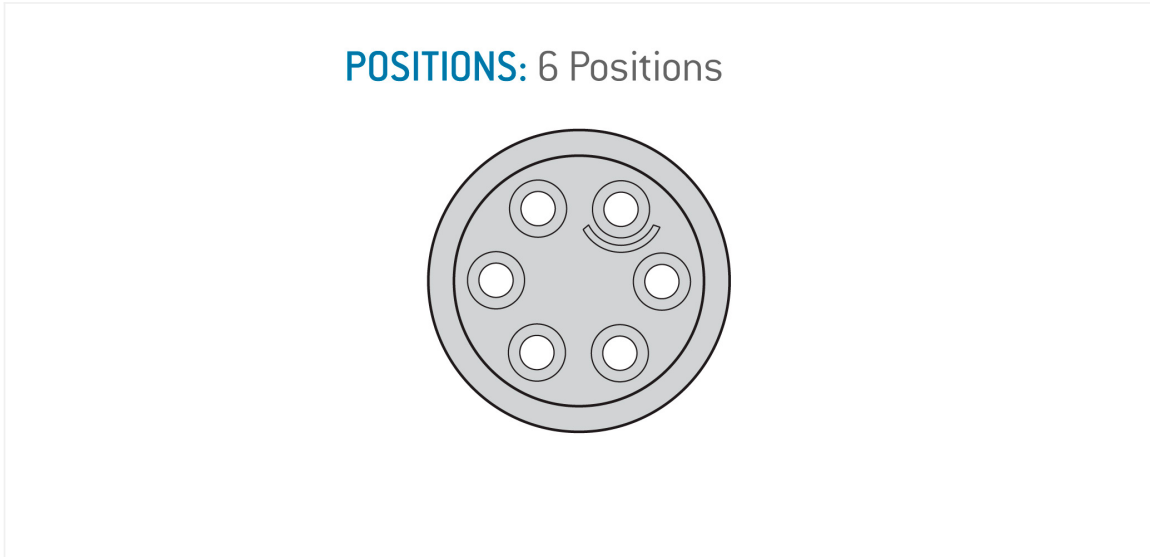
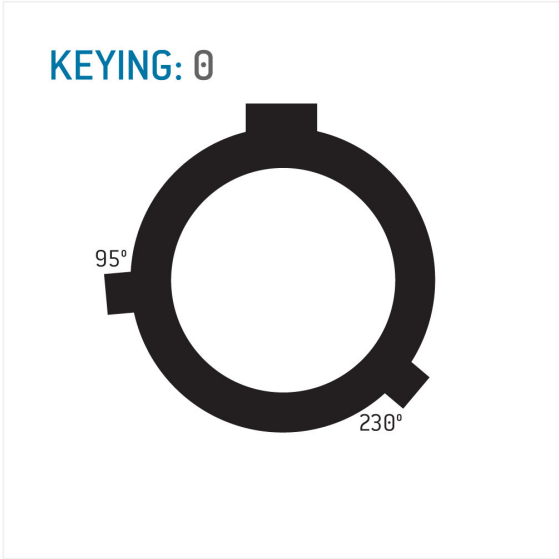
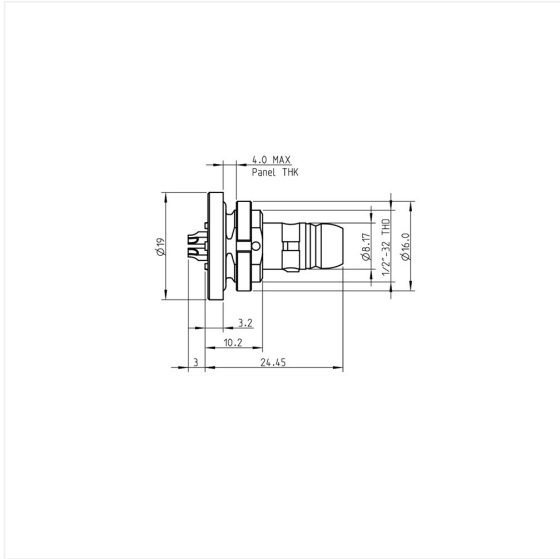

Further technical information and downloads

[3D-File \(STP File\)](#)